



Technical Features



RAL 9016
standard



Other colors
on request



Stainless
steel



Range
Up to 4,2 m



Heating types
E : electrical 3 stages
P : water
A : unheated



Casing
Galvanised Steel [*]



Airflow / Length
2500 - 6650 m3/h
1,5 m to 2,5 m



Heating capacity
E : 3,5 - 30,5 kW
P : 13,08 - 34,23 kW



Grille type
**Micro-perforated
with prefilter function**



Fans
**Centrifugal
5-speed**



Control
**Plug&Play manual regulator
+ IR remote control**



Outlet lamellas
Aluminium, airfoil type
Adjustable 0-15° each side

[*] Customizable dimensions on request

INVISAIR air curtain is designed to be installed invisibly in false ceilings and columns or drawers around the door. It is an ideal solution for those entrances that for architectural reasons require an air curtain installation that is fully integrated into the interior design of the building. Casing painted in RAL 9016. Other colors are available on request.

It can be vertically or horizontally mounted. The air flow of Invisair follows a straight line from the air inlet grille to the to the discharge. Inlet area inside a bulkhead or column should be designed with suitable grille provided by others.

This air curtain model works with double-inlet centrifugal fans driven by an external rotor motor with low noise level. EC models assembled with very low consumption efficiency fans.

Includes Plug&Play control with 7 m RJ45 cable, infrared remote control and magnetic door contact. For electrical heated models also includes thermostat.

CSA certified.

 UNHEATED 208V-1ph~60Hz

Model	Airflow	Ventilation power	Ventilation current	Noise level	Weight
	m3/h	208V-1ph~60Hz kW	208V-1ph~60Hz A	(5 m) dB(A)	
IG 1500 A	3100	0,442	2,14	57	60
IG 2000 A	4650	0,663	3,21	58	78
IG 2500 A	5425	0,774	3,75	59	83
IECG 1500 A	3600	0,425	3,72	61	60
IECG 2000 A	5400	0,638	5,58	62	78
IECG 2500 A	6300	0,744	6,51	63	83



✿ UNHEATED 240V-1ph~60Hz

Model	Airflow	Ventilation power 240V-1ph~60Hz	Ventilation current 240V-1ph~60Hz	Noise level (5 m)	Weight
	m3/h	kW	A	dB(A)	kg
IG 1500 A	3300	0,526	2,20	58	60
IG 2000 A	4950	0,789	3,30	59	78
IG 2500 A	5775	0,921	3,85	60	83
IECG 1500 A	3800	0,508	3,92	62	60
IECG 2000 A	5700	0,762	5,88	63	78
IECG 2500 A	6650	0,889	6,86	64	83

⚡ ELECTRIC HEATED 208V-1ph~60Hz

Model	Airflow m3/h	Electrical heating capacity (*) 208V-3ph~60Hz	Electrical heating capacity (*) 460V-3ph~60Hz	Electrical heating capacity (*) 480V-3ph~60Hz	Electrical heating capacity (*) 575V-3ph~60Hz	Ventilation power 208V-1ph~60Hz	Ventilation current 208V-1ph~60Hz	Noise level (5 m)	Weight
		kW	kW	kW	kW	kW	A	dB(A)	kg
IG 1500 E	3000	3,5/6,5/10	3,5/7/10,5	4/7,5/11,5	5/5,5/10,5	0,442	2,14	57	73
IG 2000 E	4500	5/9/14	5/10,5/15,5	5,5/11/16,5	6,5/8/14,5	0,663	3,21	58	96
IG 2500 E	5250	5,5/9/14,5	6/12/18	6,5/13/19,5	8/9,5/17,5	0,774	3,75	59	103
IECG 1500 E	3600	6/9,5/15,5	5,5/10,5/16	5,8/11,7/17,5	5,5/11/16,5	0,425	3,72	61	73
IECG 2000 E	5400	5/9/14	8/16,5/24,5	8,8/17,7/26,5	8/16/24	0,638	5,58	62	96
IECG 2500 E	6300	5,5/9/14,5	9,5/18,5/28	10,2/20,3/30,5	9,5/19/28,5	0,744	6,51	63	103

(*) Under request other electrical heating power can be limited.

For 208V~3ph~60Hz air Curtains there is only needed to connect three-phase power supply.

For the rest of air curtains, there is needed to connect both three-phase (for electrical heating) and single phase (for fans).

⚡ ELECTRIC HEATED 240V-1ph~60Hz

Model	Airflow m3/h	Electrical heating capacity (*) 208V-3ph~60Hz	Electrical heating capacity (*) 460V-3ph~60Hz	Electrical heating capacity (*) 480V-3ph~60Hz	Electrical heating capacity (*) 575V-3ph~60Hz	Ventilation power 240V-1ph~60Hz	Ventilation current 240V-1ph~60Hz	Noise level (5 m)	Weight
		kW	kW	kW	kW	kW	A	dB(A)	kg
IG 1500 E	3200	6/9,5/15,5	5,3/10,7/16	5,8/11,7/17,5	5,5/11/16,5	0,526	2,20	58	73
IG 2000 E	4800	5/9/14	8,2/16,3/24,5	8,8/17,7/26,5	8/16/24	0,789	3,30	59	96
IG 2500 E	5600	5,5/9/14,5	9,3/18,7/28	10,2/20,3/30,5	9,5/19/28,5	0,921	3,85	60	103
IECG 1500 E	3700	6/9,5/15,5	5,3/10,7/16	5,8/11,7/17,5	5,5/11/16,5	0,508	3,92	62	73
IECG 2000 E	5550	5/9/14	8,2/16,3/24,5	8,8/17,7/26,5	8/16/24	0,762	5,88	63	96
IECG 2500 E	6475	5,5/9/14,5	9,3/18,7/28	10,2/20,3/30,5	9,5/19/28,5	0,889	6,86	64	103

(*) Under request other electrical heating power can be limited.



 WATER HEATED 208V-1ph~60Hz

Model	Airflow m3/h	P86 (80/60°C)		P64 (60/40°C)		P54 (50/40°C)		Ventilation power (*) kW	Ventilation current (*) A	Noise level (5 m) dB(A)	Weight kg
		Water heating capacity kW	Water pressure drop Pa	Water heating capacity kW	Water pressure drop Pa	Water heating capacity kW	Water pressure drop Pa				
		IG 1500 P	2500	14,3	770	13,08	6490				
IG 2000 P	3750	22,29	2210	18,86	5530	19,4	2410	0,663	3,21	58	89
IG 2500 P	4375	27,84	4040	22,48	4100	24,07	4330	0,774	3,75	59	94
IECG 1500 P	3400	17,29	1070	15,97	9240	17,02	6630	0,427	3,81	61	69
IECG 2000 P	5100	26,87	3080	22,99	7850	24,05	3530	0,640	5,72	62	89
IECG 2500 P	5950	33,64	5650	27,48	5840	29,9	6370	0,747	6,67	63	94

Water heated: connection pipes P86 and P64 are 2x3/4" female (male if lateral pipes), P54 2x1" male.

P86 2 rows coil, P64 3 rows coil, P54 4 rows coil.

(*) Voltage 208-1ph~60Hz

 WATER HEATED 240V-1ph~60Hz

Model	Airflow m3/h	P86 (80/60°C)		P64 (60/40°C)		P54 (50/40°C)		Ventilation power (*) kW	Ventilation current (*) A	Noise level (5 m) dB(A)	Weight kg
		Water heating capacity kW	Water pressure drop Pa	Water heating capacity kW	Water pressure drop Pa	Water heating capacity kW	Water pressure drop Pa				
		IG 1500 P	3000	16,02	940	14,74	8020				
IG 2000 P	4500	24,92	2700	21,23	6820	22,06	3030	0,789	3,30	59	89
IG 2500 P	5250	31,17	4940	25,35	5070	27,41	5450	0,921	3,85	60	94
IECG 1500 P	3500	17,59	1110	16,27	9550	17,36	3500	0,508	3,92	62	69
IECG 2000 P	5250	27,34	3180	23,42	8110	24,53	3660	0,762	5,88	63	89
IECG 2500 P	6125	34,23	5830	27,99	6040	30,51	6600	0,889	6,86	64	94

Water heated: connection pipes P86 and P64 are 2x3/4" female (male if lateral pipes), P54 2x1" male.

P86 2 rows coil, P64 3 rows coil, P54 4 rows coil.

(*) Voltage 240-1ph~60Hz



Selection program



Dimensions

Horizontal installation

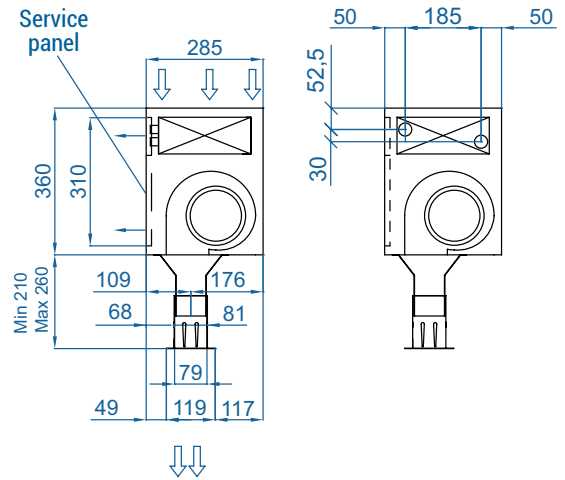
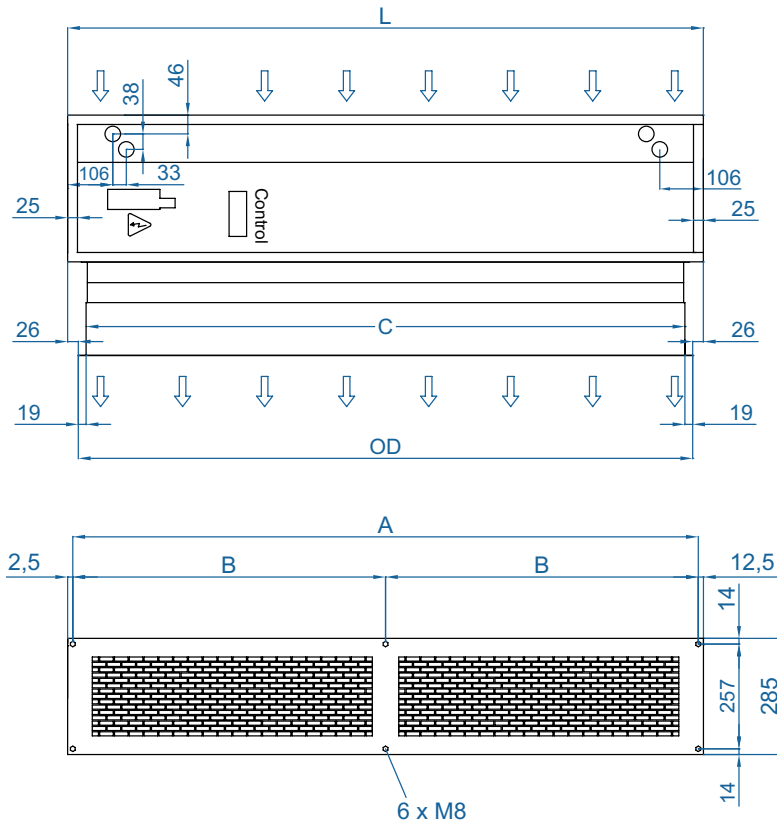

Model	L	A	B	C	OD
1500	1550	1525	762,5	1461	1498
2000	2055	2030	1015	1961	1998
2500	2555	2530	1265	2461	2498

Customizable dimensions on request

Vertical installation

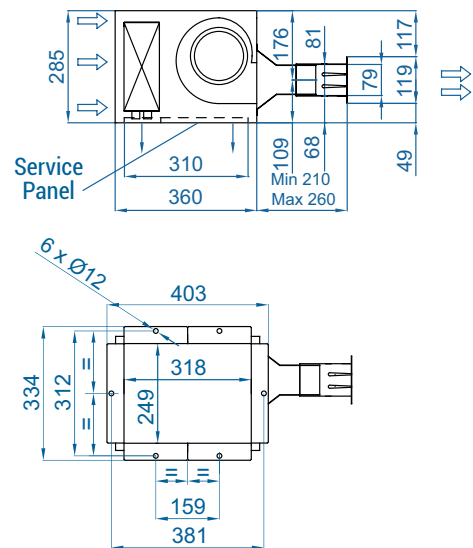
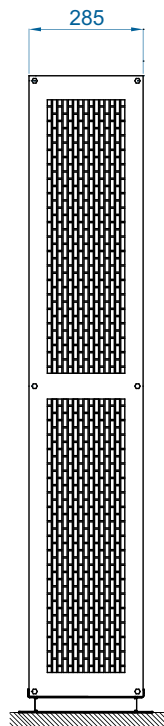
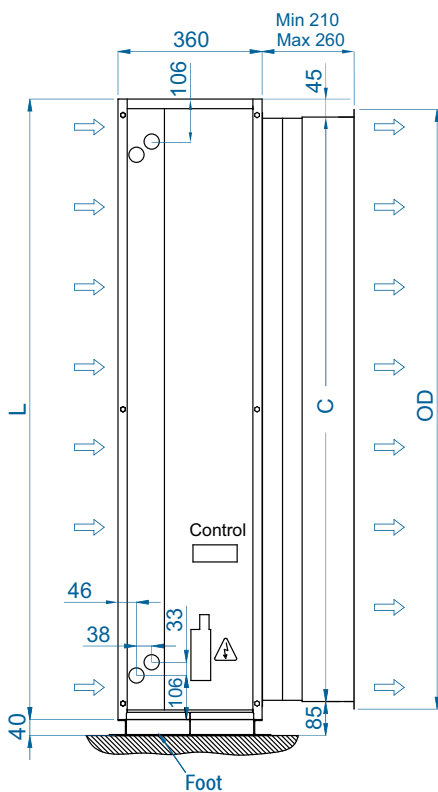

CAD drawings, installation manuals
and other documentation



Installation configurations



Optional accessories

Supports and installation



Wall rail support
SPWR



Silentblock supports
SPANG-SIL / SLB



Suspension cables
SPCT



Wall angle support
Invisair MG



Flat inlet grille



Foot support
SPF-INVISAIR
(Galv.)



Joining kit
SPJ-INVISAIR
(Galv.)

Control



IR Control
✓ Included



Basic Control
✓ Included



RJ45 Cable
✓ Included



Hand-Auto
CH-5HW-NE



Interface kit
IN-NE-II

Sensors



Magnetic
door contact MAG-DC
✓ Included



Mechanical
door contact MEC-DC