



Characteristics



- Specially designed for insects control at windows of food establishments and industries, tolls and kiosks.
- High velocity air barrier to prevent flying insects from entering a building, according to NSF 37 standard.
- Self-supporting casing construction made of galvanized steel plate, finished in structural epoxy-polyester painting white colour RAL9016 as standard. Other colours are available on request.
- Large perforated inlet grille avoiding intensive maintenance.
- Anodized aluminium outlet vanes, airfoil shaped, adjustable in both directions.
- Double-inlet centrifugal fans driven by an external rotor motor with 2-speed selector (comfort and fly mode).
- "A" type without heating, air only.
- Included regulation with infrared remote control and inbuilt keypad with leds.

Specifications

AIR ONLY

| Model | Airflow m ³ /h | Power Fans 230V-50Hz W | Current Fans 230V-50Hz A | Noise Level (5 m) dB(A) | Weight kg |
|-----------------------|------------------------------|---------------------------------|-----------------------------------|----------------------------------|--------------|
| COMPACT FLY 600 A | 1150 | 318 | 1,43 | 51/67 | 13 |
| COMPACT FLY 900 A (*) | 1725 | 478 | 2,15 | 52/68 | 18,5 |

(*) Provisional data, under revision.

Dimensions

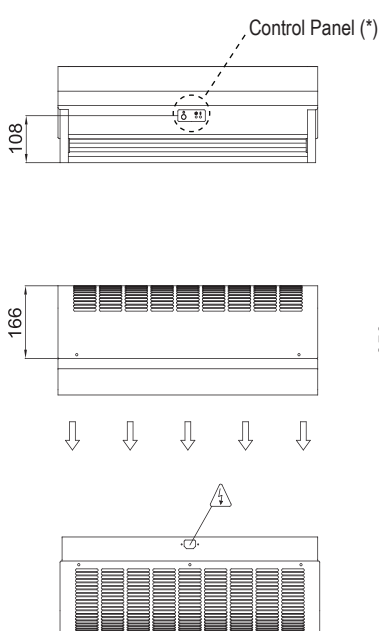

| | L | A |
|-----------------|-----|-----|
| COMPACT FLY 600 | 630 | 554 |
| COMPACT FLY 900 | 930 | 854 |

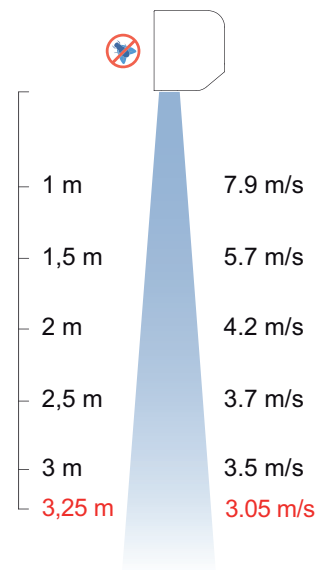
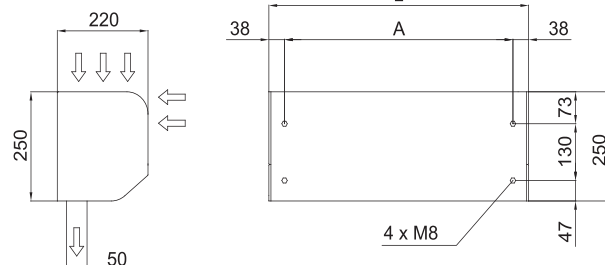

(*) Manual regulation using inbuilt keypad or by infrared remote control

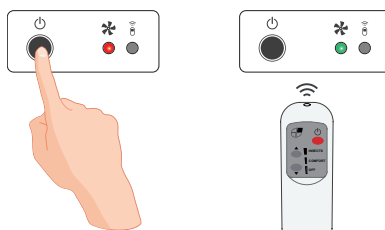

According to standard NSF-37-2012, in service windows must be an air jet at 3,05m/s of 200mm width at 1/3 of the window counter top.